

One of our recently completed projects in Marredpally



Vinayaka's Kausthuba Abode
East Marredpally

Vinayaka's 
Sahitha Abode

In perfect harmony ... Location, Lifestyle and Elegance.

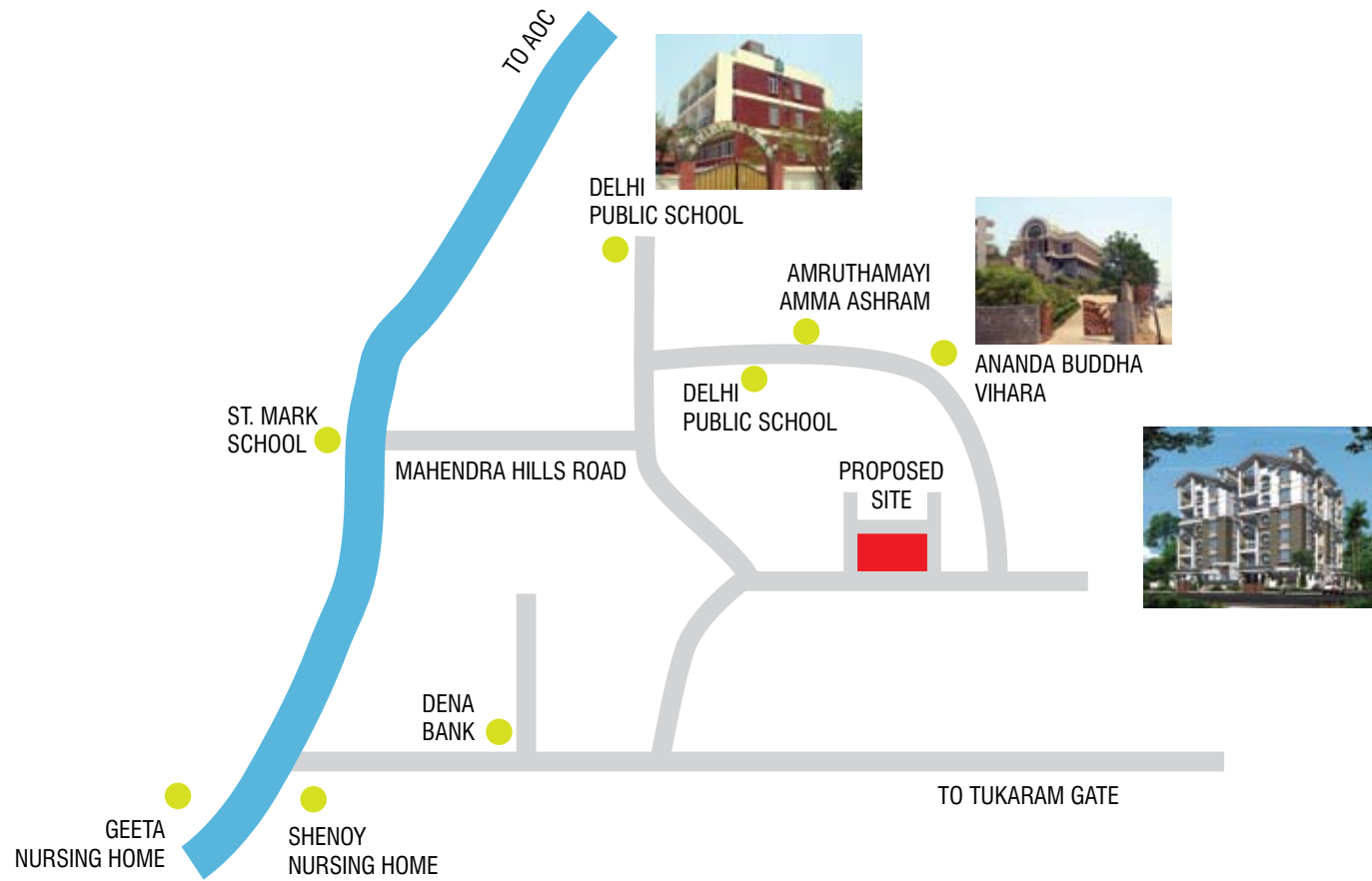

GRAPHIC STUDIO, Ph : 98892 33490

Builders & Promoters:

VINAYAKA ESTATES

H.No.17-119/87,88,89 &90, Annapurna Co-op Housing Society
Mahindra Hills, Secunderabad.
Contact: 8106961222, 9000334478

Architects :

PR Associates

3-5-170/A/6, Shanthi Theatre Road
Narayanguda, Hyderabad
Ph : 040 65767775

VINAYAKA
ESTATES

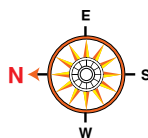
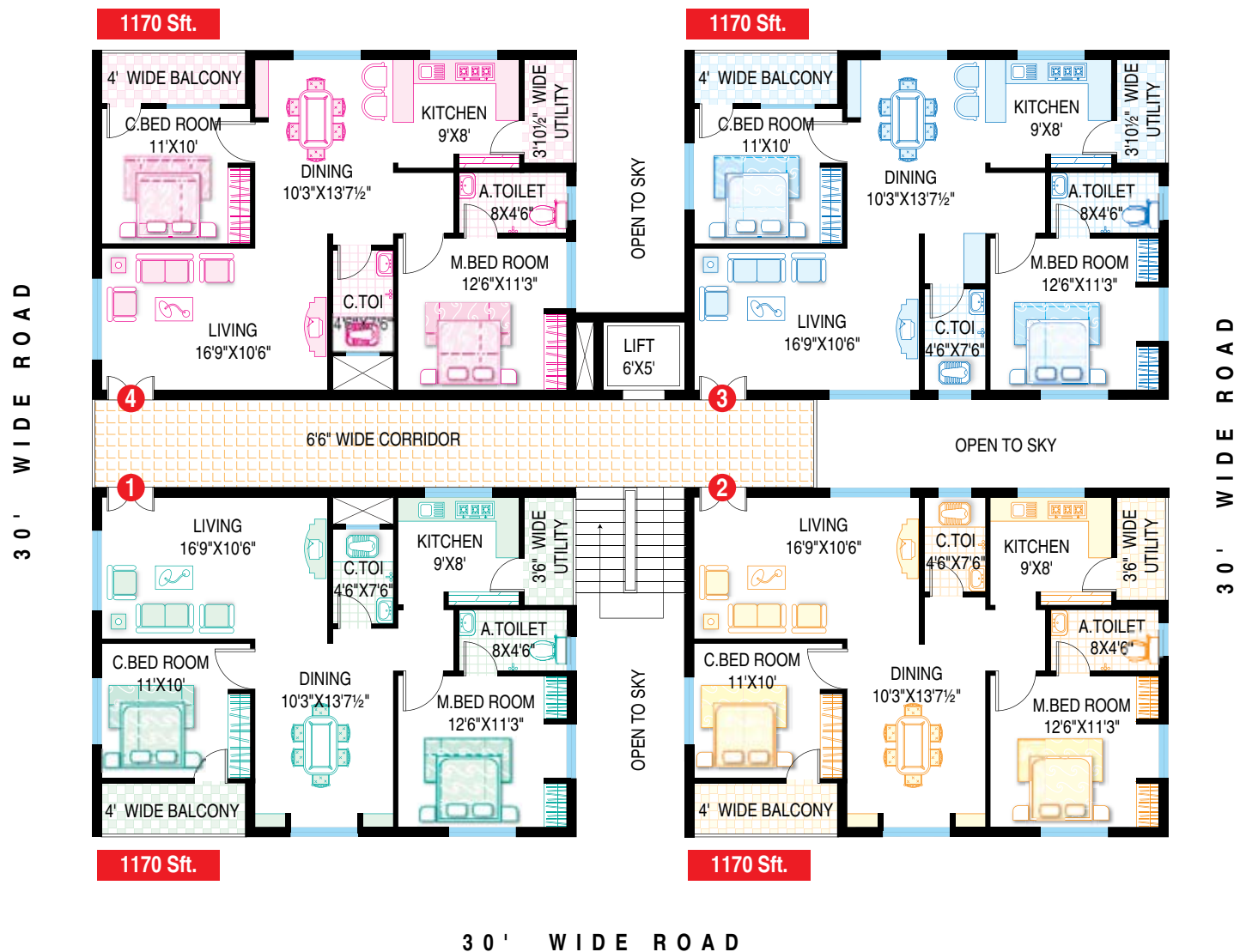

- STRUCTURE** : RCC framed structure.
- SUPER STRUCTURE** : Table mounded Bricks with cement mortar.
- INTERCOM** : Intercom Facility for all flats connecting to security.
- MAIN DOOR** : Teakwood frame & Teak/vener moulded paneled door with melamine polishing and designer hardware of reputed make.
- INTERNAL DOORS** : Teakwood frames & HDF skin moulded panelled door with (melamine polish for hall & living connected doors) and paint finish for other side of doors and designer hardware of reputed make
- WINDOWS** : Teakwood frames with plain glass designed shutters & safety Grills.
- PLASTERING** : Internal walls with NCL altek luppam finish & external with sponge finish.
- FLOORING** : First quality vitrified tiles 24" x 24" in Drawing, Dining & Bedrooms, and anti-skid ceramic tiles in bathrooms and Wash Balcony.
- KITCHEN** : Granite Platform with steel sink, 2' height Tiles dadoing on cooking platform.
- TOILETS** : CP Jaquar/Mark hot and cold wall mixers & taps in each toilet with geyser provision. Johnson/Sonora or equal brand concept model tiles upto door height in each toilet . Wash basins with pedestal & Cascades of Hindustan /Parryware or equivalent make.
- PAINTING** : Plastic Emulsion paint for internal walls. Water proof paints for exterior walls.
- P.O.P BORDER** : P.O.P border for Drawing , Dining and all Bedrooms.
- ELECTRICAL** : Concealed Copper wiring, Modular Switches with metal boxes Electrification with adequate light, fan points and providing sockets of standard make of Fridge, Washing Machine, Mixer and A.C point for master bedroom.
- TV/TELEPHONE** : TV and Telephone points in drawing/living and Master bed room.
- LIFT** : Johnson/Kone lift leading to all floors.
- GENERATOR** : Generator backup for lift, motors, common areas and Flats.
- CORRIDORS & STAIRCASE** : Granite/Marble Flooring in corridors & staircase with stainless steel railing.

Note : This Brochure is only conceptual presentation of the project and not a legal offering. The promoters reserve the right to make changes in the elevation, plans and specifications as deemed fit.

